

Installation Guide

1. The parts are as followed:



Gear motor with encoder	2	Large torque steering gear	1
Metal rudder	1	Aluminum alloy steering gear support	1
65mm rubber tire	4	Aluminum alloy platform	1
Front-wheel bearing	4	Steering cup	2
Ball head pull rod	4	Coupler	4
37 motor support	2	Acrylic platform	1
Screw bag	1		

2. Partial installation

Front wheel steering part:



Steering cup

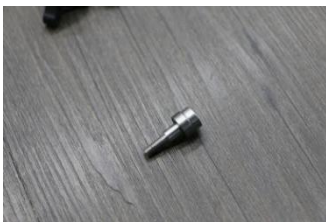
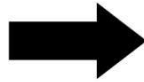

Pull rod

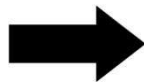

Steering

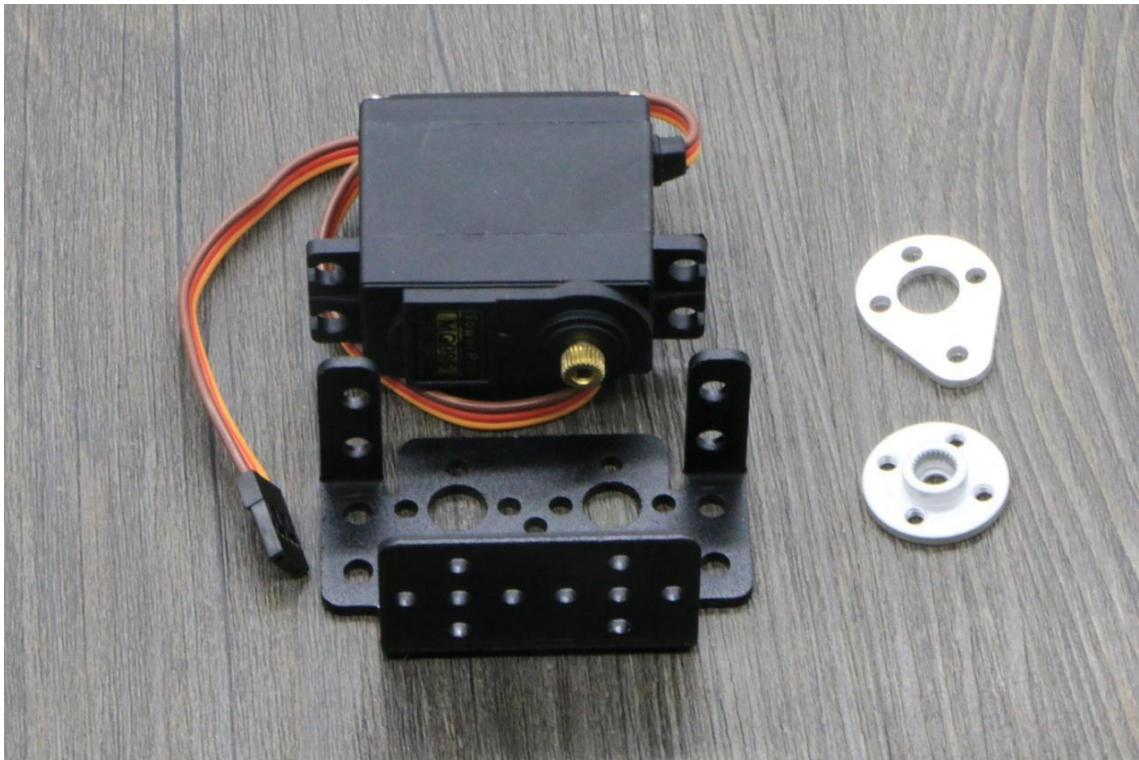

3. Starting installation

1. Assemble the multifunctional support on the aluminum alloy platform;
2. Install the steering gear assembled into the steering gear support, pay attention to the front position of the steering gear installation;
3. Install the assembled steering cup kit onto the bottom plate and pay attention to the direction (the coupling faces outward and the steering cup ears face forward).

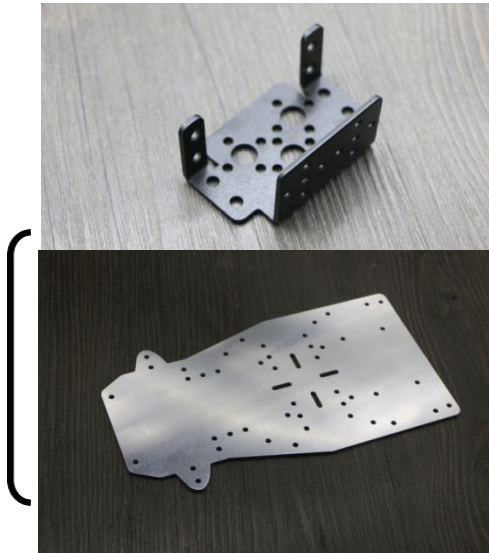

Step1: pay attention to the position of support

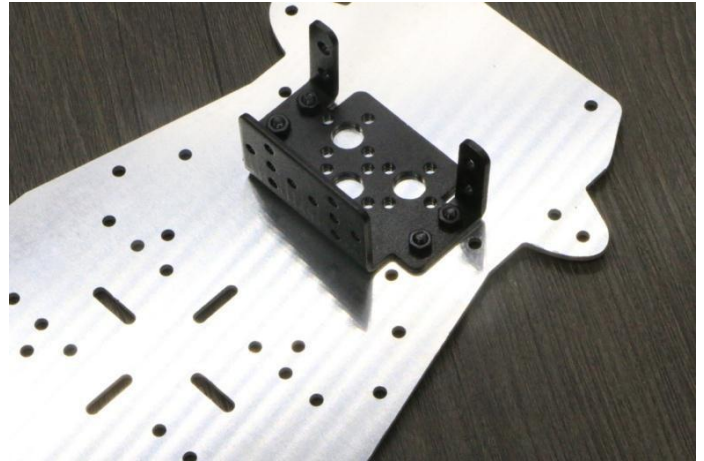

Step 3: Pay attention to the direction of the steering cup



Step 2: the steer is installed in the front

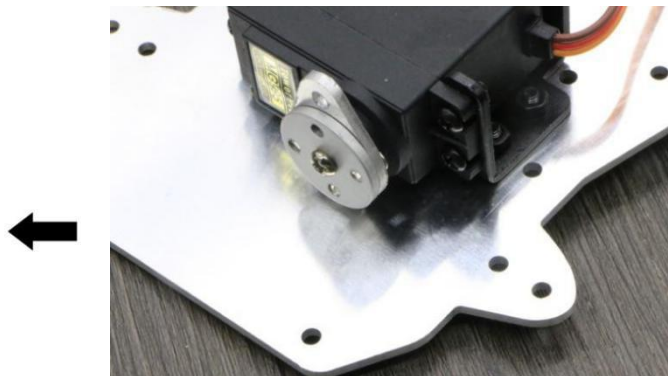

Note:

1. Servo must be adjusted to zero (the servo defaults to zero, do not twist the output shaft with your hands or parts);
2. Selection of steering bracket holes;
3. When fix the steering gear, the installation position is in front of it, don't forcibly clamp it in the middle of the support;
4. Pay attention to the direction of the steering cup components, the ear of the steering cup is in front, and the coupling is facing forward;
5. Fix the upper end of the steering cup with a copper post and a connection piece. Note that the connection piece and the upper end of the steering cup have a space to avoid, and the screw can not be tightened;
6. Connect the steering cup with a ball puller (long), pay attention to adjust the length of the pull rod to the front wheel coupling in a horizontal position;
7. Connect the rocker arm to the front wheel tie rod with a ball pull rod (short), pay attention to adjust the length the length of the tie rod. When the steering gear is at zero, the front wheel pull is in the horizontal position.

Step4: pay attention to the distance between the connector and the steering cup.

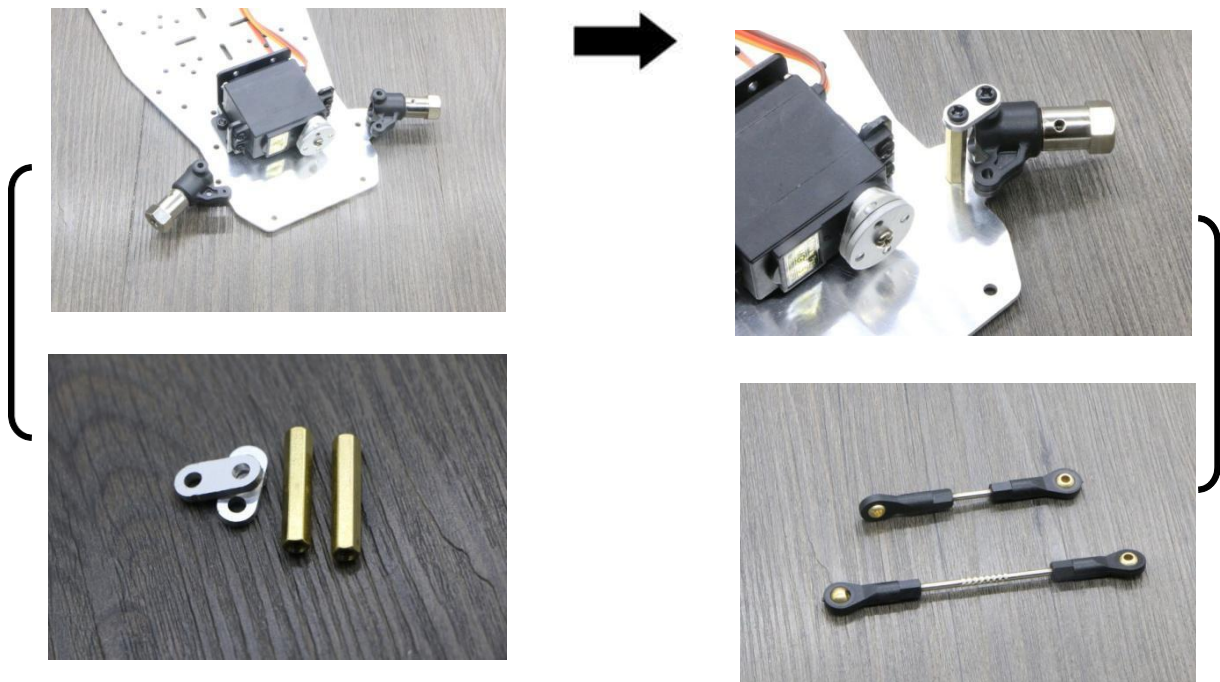

Step5: adjusting the length of the pulling rod

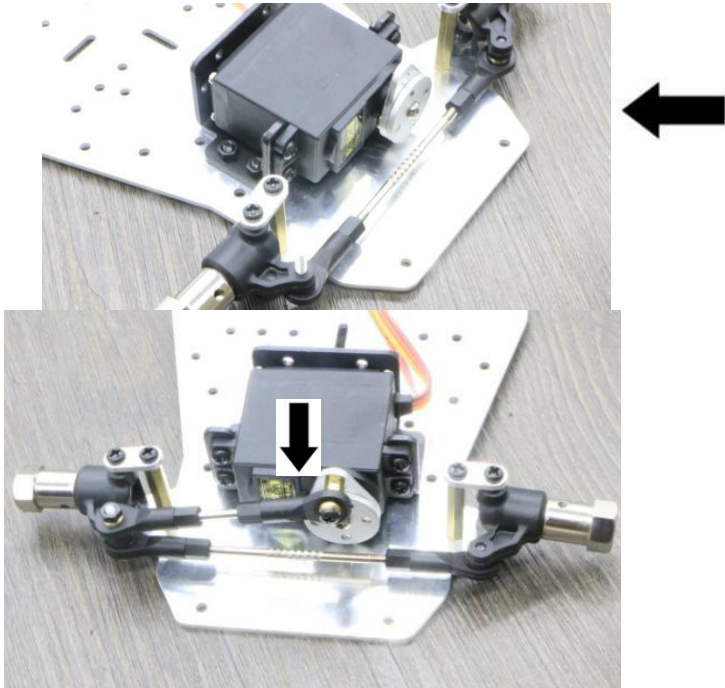

Step6: adjust the length of pull rod with steering gear zero, steering cup position, do not arbitrarily twist the steering gear output shaft position.

Step7: install the motor support on the aluminum alloy platform and coordinate the height of the front and rear wheels.



Step8: install the motor onto the motor support, and the output shaft facing down.

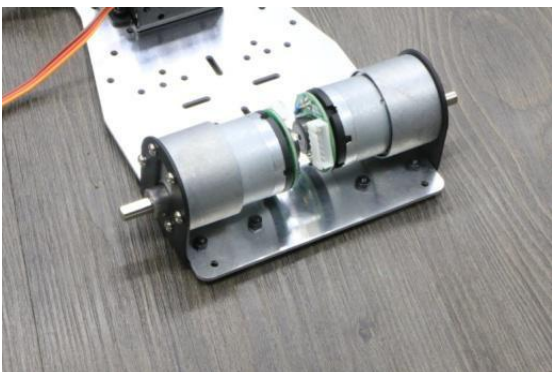

Step9: install coupling to the motor, remember distinguish front and rear wheel coupling.



Step10: tire installation, add gasket to the outside of the screw.

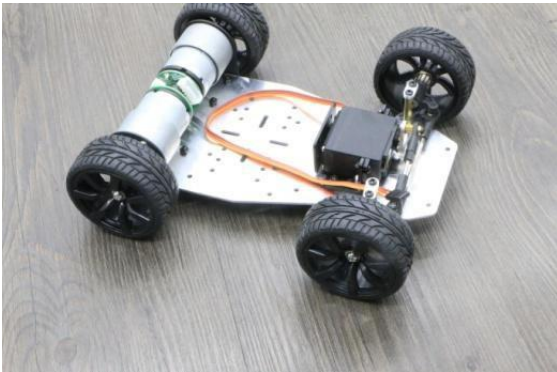

Step11: installation of upper acrylic platform, pay attention to the orientation of copper columns.

