

ThinkNode M7

LoRaWAN Gateway

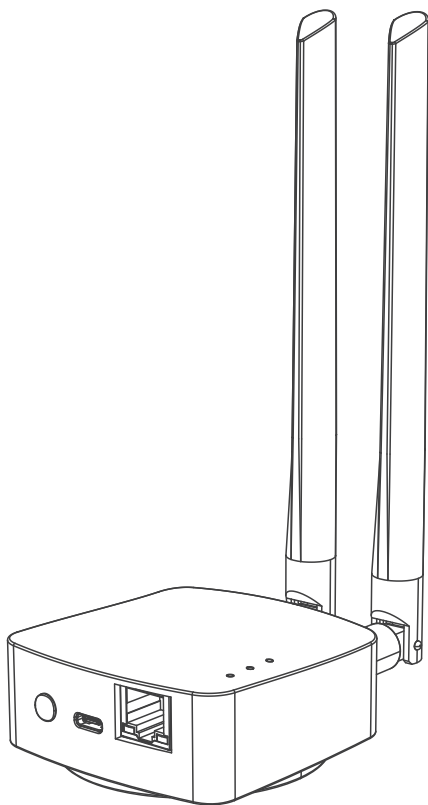

User Manual

Device Part

- ① Reload Button
- ② USB-5V (Console)
- ③ Ethernet Port (10Mbps/100Mbps)
- ④ BT Status LED
- ⑤ LoRa Status LED
- ⑥ PWR Status LED
- ⑦ WLAN/BT Antenna
- ⑧ LoRa Antenna

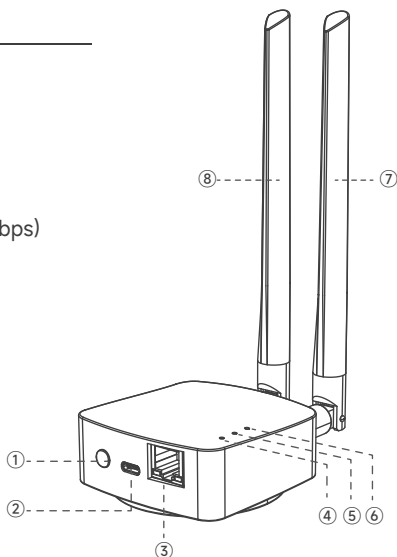

Product LED

1. When the device is powered on, the red LED (PWR) remains solid.
2. During data transmission, the blue LED (LoRa) blinks.
3. After the device is connected to Wi-Fi or Ethernet, the green LED (BT) remains solid.

Wi-Fi Setup

1. Power the gateway via the Type-C cable, then press and hold the Reload button for 5 seconds and release. The green LED (BT) will blink. This indicates that the device has entered gateway configuration mode. (Note: Without saved configuration, the device enters configuration mode automatically on power-on. To reconfigure, long press Reload for 5 seconds.) Use a computer or mobile phone to connect to the gateway's Wi-Fi network (ThinkNode-M7_xxxxx), with the password: 88888888.

2. Open a browser and enter 192.168.4.1 to access the gateway configuration page:

- NET MODE: WIFI
- WiFi SSID: Enter the Wi-Fi name you want to connect to (non-5GHz Wi-Fi network)
- WiFi PASS: Enter the password for the Wi-Fi network you want to connect to
- Gateway ID: xxxxxxfffxxxxxx (Click GatewayID Default)
- SERVER ADDR: eu1.cloud.thethings.network (Default)
- SERVER PORT: 1700 (Default)

- REGION: EU868 / US915 / AU915 (Select according to the actual frequency band)
- CHANNEL: * (Choose according to the frequency of the connected device) (Default 0)
- SF: ** (Choose according to the frequency of the connected device) (Select '12' for EU868MHz, '10' for US915MHz, and '10' for AU915MHz.)
- TIME_ZONE: UTC (Select the UTC time zone of your location)

3. Click Submit to save the configuration settings. The gateway will automatically reboot, and the green LED (BT) will turn off temporarily, then remain solid.

Ethernet Setup

1. Plug the PoE adapter into a power outlet, connect The Ethernet cable to the WAN port, and use a RJ45 cable to connect the PoE port to the Ethernet port on the gateway. The green LED (BT) will blink. This indicates that the device has entered gateway configuration mode. (Note: Without saved configuration, the device enters configuration mode automatically on power-on. To reconfigure, long press Reload for 5 seconds.) Use a computer or mobile phone to connect to the gateway's Wi-Fi network (ThinkNode-M7_XXXXXX), with the password: 88888888.

2. Open a browser and enter 192.168.4.1 to access the gateway configuration page:

- NET MODE: NET
- WiFi SSID:
- WiFi PASS:
- Gateway ID: xxxxxxxffexxxxxx (Click GatewayID Default)
- SERVER ADDR: eu1.cloud.thethings.network (Default)
- SERVER PORT: 1700 (Default)
- REGION: EU868 / US915 / AU915 (Select according to the actual frequency band)
- CHANNEL: * (Choose according to the frequency of the connected device) (Default 0)
- SF: ** (Choose according to the frequency of the connected device) (Select '12' for EU868MHz, '10' for US915MHz, and '10' for AU915MHz.)
- TIME_ZONE: UTC (Select the UTC time zone of your location)

3. Click Submit to save the configuration settings. The gateway will automatically reboot, and the green LED (BT) will turn off temporarily, then remain solid.

PoE Wiring Method

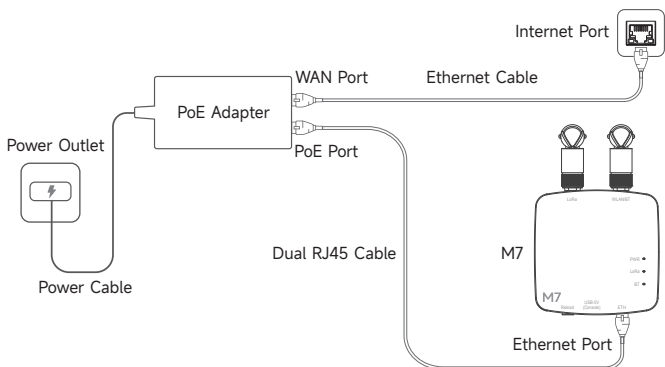

For M7 devices with PoE support.

Base Installation

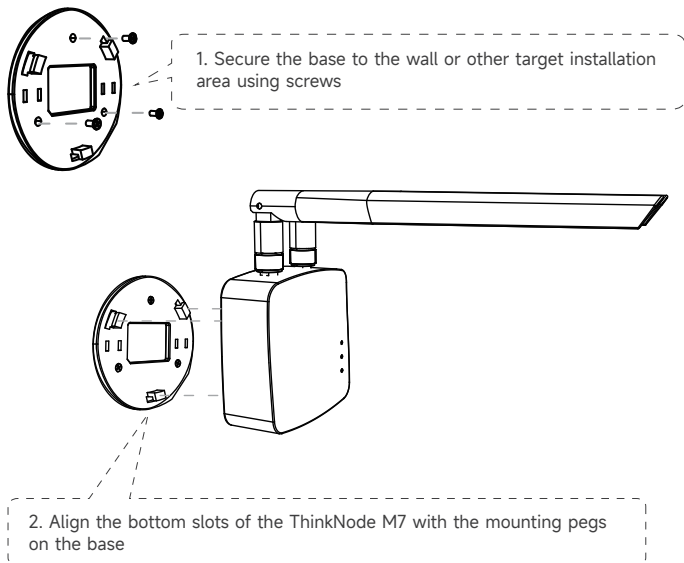

3. Rotate the ThinkNode M7 clockwise until it locks securely into position

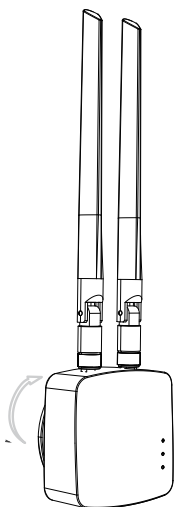

Main Specifications

Product Name	ThinkNode M7
Power Supply	5V/1A (USB Type-C); PoE (IEEE 802.3af), 37V-57V DC
Weight	108 g
Dimensions	75*75*30mm (Excluding antenna)
Interfaces	Type-C (USB), RP-SMA (LoRa&WLAN/BT), RJ45 (WAN/LAN)
LoRa Sensitivity	-125dBm @125K/SF7, -139dBm @125K/SF12
LoRa TX Power	22dBm
WiFi	Support 2.4 GHz 802.11 b/g/n
Bluetooth	Dual-Mode Bluetooth-BR/EDR+BLE 5.0
Antenna Gain	LoRa: 4dBi External Antenna, WLAN/BT: 4dBi External Antenna

Parts List

- ThinkNode M7 x1
- LoRa Antenna x1
- WLAN/BT Antenna x1
- USB-A to USB-C Data Cable x1
- Base x1
- User Manual x1

Service & Support

If you have any questions, customer support is always stand by.



info@elecrow.com



techsupport@elecrow.com

Made in China