

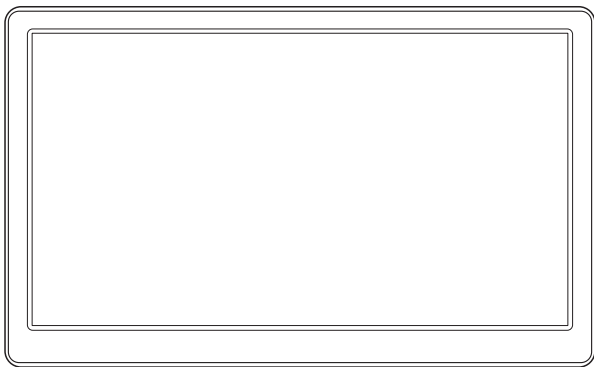

ELECROW 15.6 inch Portable Touchscreen Monitor



User Manual

Please read this instruction carefully before using this 15.6" display
and keep it for future reference.

Package Include

- ◇ 15.6 inch Display x 1
- ◇ Power Adapter x 1
- ◇ USB A to Type-C cable x 1
- ◇ Type C to Type C cable x 1
- ◇ HDMI to Mini HDMI Connecting Cable x 1
- ◇ Stand x 1

Button & Interface Function

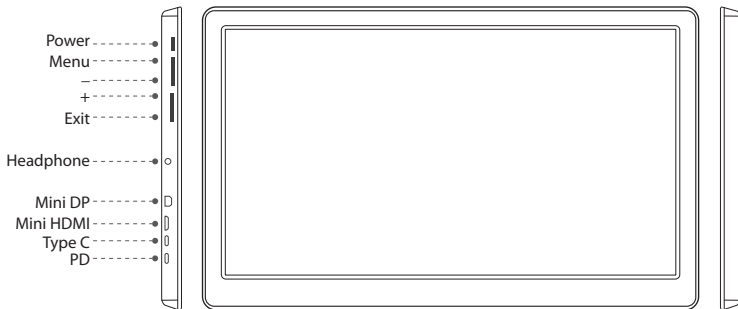





Icon	Description
Power	To turn on/of the screen
Menu/-/+ /Exit	1.Press Menu to launch OSD panel.
	2.Use +/- to navigate the menu or to adjust a value in the OSD.
	3.Press Menu to select or enter the next page.
	4.Press Exit to cancel the set value or exit OSD.
-	Press - to enter low blue ray menu, use +/- to adjust the mode.
+	Press + to enter brightness menu, use +/- to adjust the value.
Exit	Press Exit to enter signal source menu, use +/- to select "DP", "HDMI" or "Type C".
HP	3.5mm headphone jack for audio output
Mini DP	DP Port---for video transfer
Mini HDMI	Mini HDMI Port---for video transfer
Type C	Type C Port---for touch function and power supply
PD	PD Port---just for power supply

Product Parameters

Screen Size: 15.6 inch	Resolution: 1920*1080 Full HD
Panel Type: IPS FHD	Aspect Ratio: 16:9
Brightness: 400 cd/m ²	Refresh Rate: 85Hz
Viewing Angle: 85/85/85/85	Contrast: 1000:1
Shell Material: Plastic	Supply Voltage: 5V/2A (USB Type C)
Input: 1*Mini DP/ 1*Mini HDMI / 1*Type C	Audio Output: 3.5mm headphone jack
Monitor Weight: 720g	Monitor Size: 375×230×12mm

Menu Operation

Top Menus	Sub Menus	Description
	Brightness	Control the screen brightness (adjust range 0-100)
	Contrast	Control the contrast of the pictures displayed on the screen (adjust range 0-100)
	Sharpness	Control the clarity of details of pictures displayed on the screen(adjust range 0-4)
	Aspect Ratio	Select the aspect ratio of the input signal to "Full", "16:9", "4:3""5:4" or "1:1" models
	Ultra Vivid	Select the mode of "off", "low", "middle" or "high"
	DCR	Select the dynamic contrast ratio on/off
	Color Effect	Select the color mode of "standard", "vivid", "photo", "movie" or "game"
	Saturation	Adjust the color saturation among 0-100
	Gamma	Contains three gamma modes including "off", "1.8", "2.2" or "2.4"
	Temperature	Contains four color modes including "User", "9300", "6500" or "5400"
	R	Adjust the red color value of pictures according to your reference
	G	Adjust the green color value of pictures according to your reference
	B	Adjust the blue color value of pictures according to your reference
	Volume	Adjust the volume value according to your preference
	Mute	Select the mute mode on/ff to control audio output
	Over Drive	Select the over drive on/off to adjust the pixel response time
	Low Blue Ray	Select the low blue ray mode of pictures of "off", "low", "middle" or "high"
	Language	Select a language for the OSD
	Menu Time	Adjust the OSD Timeout (adjust range 10-60)
	OSD H. POS.	Adjust the horizontal position of the OSD
	OSD V. POS.	Adjust the vertical position of the OSD
	Reset	Restore the various parameters value settings to the factory defaults
		Display the information of using signal source, resolution, etc

How to Use as PC Monitor

1. Connect one input port (Mini HDMI, Mini DP) of the monitor to your output device (such as laptop).
2. Power the monitor by connecting Type C (not PD) port of the monitor to USB Type A port of your device.
3. Press the Power button of the monitor.

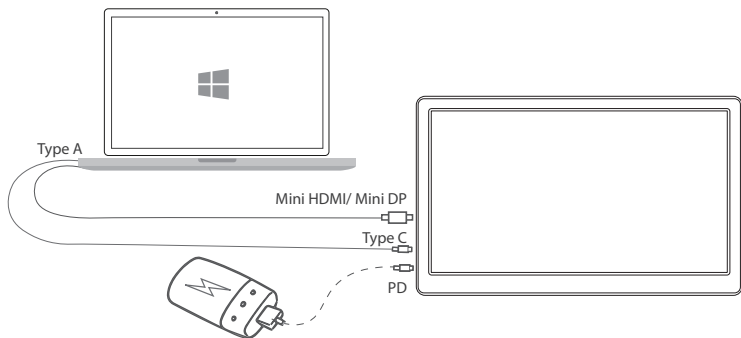

* Touch function is only available when connecting to Windows OS laptop and powered the Type C port by the output device.

* You could also choose to power the monitor by connecting Type C/PD to a power adapter/power bank, but in this case, the touch function will not be available.

Tech Support

If you have any concern about our products and services, please do not hesitate to contact us by one of the following ways:

- ◇ For Sales Support: **info@elecrow.com**
- ◇ Get help with order: find your order in your order list and leave us a message with your question.